

LP Delta Trap – ASSEMBLY & USE

Item List: Large Plastic Trap • 2 Inserts (CAUTION: STICKY) • Wire Hanger

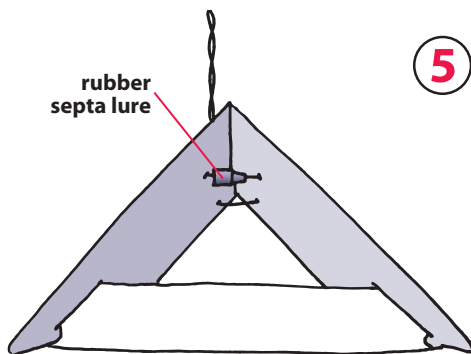
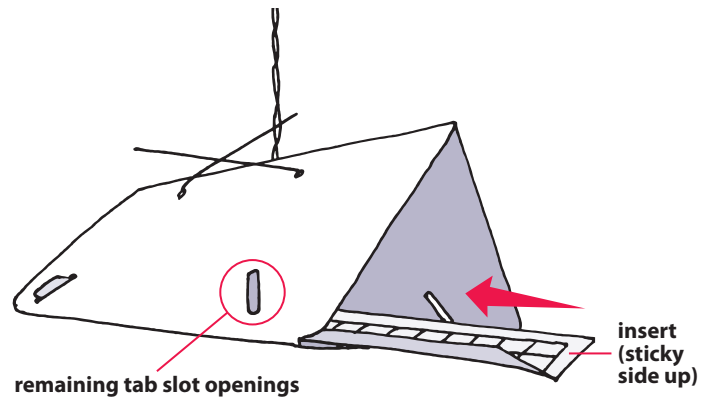
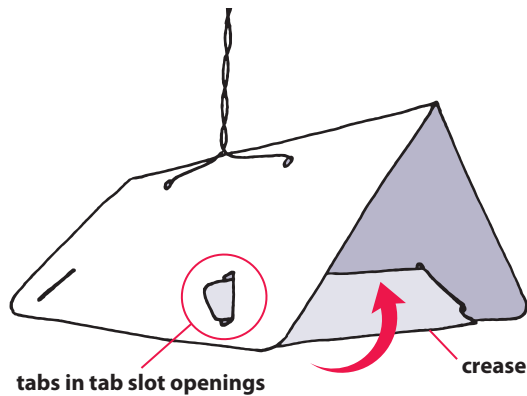
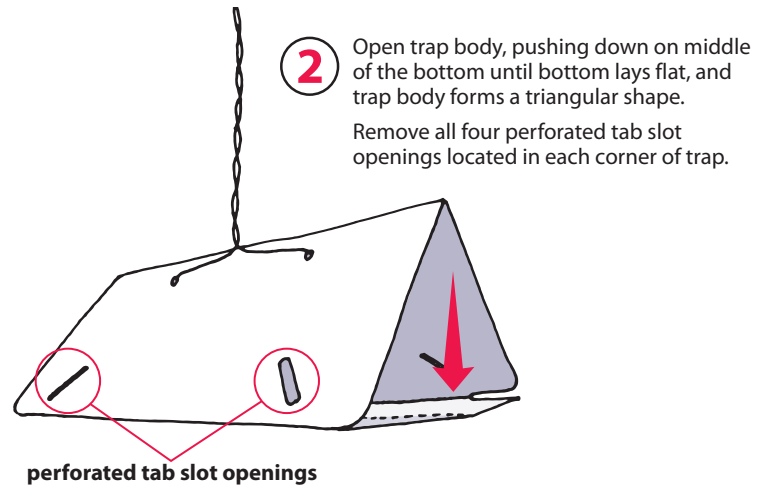
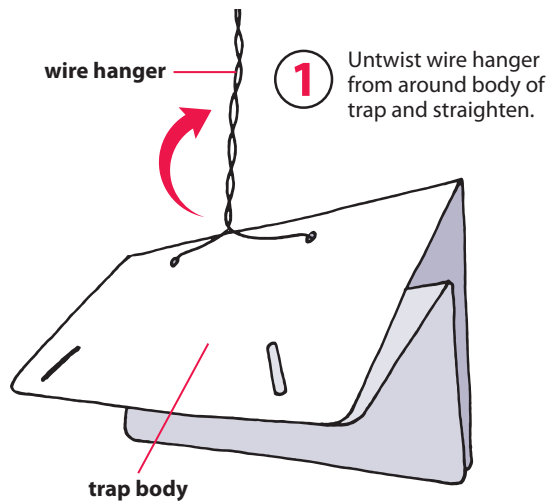

Rubber Septa Lure: Place lure on wire hanger inside trap.

Fiber Lure:

Remove backing from lure and adhere to inside side panel of trap. Take care to insure open ends of fibers do not become blocked with glue on trap.

All Other Lures:

Place on sticky surface of trap bottom, taking care not to coat the surface of the lure with the glue from the trap.

NOTE: To prolong storage life, refrigerate or freeze unused lures in their sealed pouch.

Use of tweezers or rubber gloves is recommended for handling septa lures to avoid contaminating septa.

To avoid cross-contamination, only handle traps and lures for one specific insect species at a time. Wash hands and working surfaces thoroughly before assembling and baiting traps for other species.

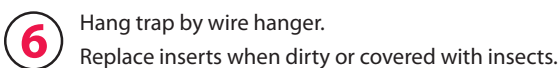

See opposite side for list of insects monitored by LP Delta Trap.

LP Delta Trap

For use in monitoring:

Apple Clearwing Moth	Honeydew Moth
Armyworm	Lesser Appleworm
Arthur's Sunflower Moth	Lesser Peachtree Borer
Artichoke Plume Moth	Light Brown Apple Moth
Beet Armyworm	Nun Moth
Blackberry Clearwing Borer	Obliquebanded Leafroller
Black Cutworm	Olive Moth/Citrus Flower Moth
Blackheaded Fireworm	Omnivorous Leafroller
Brown Marmorated Stink Bug	Orange Tortrix
Cabbage Looper	Oriental Fruit Moth
Carob Moth	Peach Twig Borer
Cherry Bark Tortrix	Plum Fruit Moth
Clearwing Borer	Redbanded Leafroller
Banded Ash Borer	Southern Armyworm
Lilac/Ash Borer	Southwestern Pine Tip Moth
Oak Borer	Soybean Looper
Peachtree Borer	Speckled Green Fruitworm
Rhododendron Borer	Spotted Fireworm
Codling Moth	Spotted Tentiform Leafminer
Cranberry Girdler/Sod Webworm	Squash Vine Borer
Currant Clearwing Moth	Strawberry Crown Moth
Diamondback Moth	Summerfruit Tortrix
Dogwood Borer	Sunflower Moth
European Grape Berry/Grape Moth	Tomato Pinworm
European Grape Vine Moth	Tufted Apple Bud Moth
False Codling Moth	Viburnum Borer/Holly Borer
Grape Tortrix	Viburnum Crown Borer
Grape Root Borer	Western Bean Cutworm
Hickory Shuckworm	Western Poplar Clearwing Moth
Honey Bee	